

HERMETIC & NON-HERMETIC SOLDER-IN "O" CAPACITANCE FEED-THROUGHS

CIRCUIT

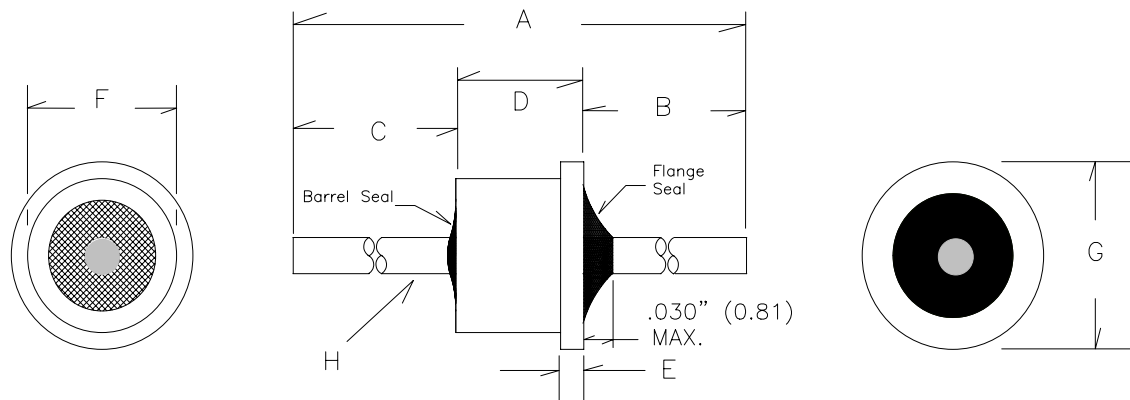

*RoHS Compliant * ISO 9001:2008 Registered*

EMI P/N	HERMETIC SEAL (Location)	FINISH	A		B		C		D		E		F		G		H	
			Inches	mm	Inches	mm	Inches	mm	Inches	mm	Inches	mm	Inches	mm	Inches	mm		
ZPC000D	NO ***	Silver	.625"	15.87	.265"	6.73	.250"	6.35	.110"	2.79	.020"	0.50	.128"	3.25	.156"	3.96	.030"	.762
ZRC000D	YES (Flange)	Gold	.625"	15.87	.265"	6.73	.250"	6.35	.110"	2.79	.020"	0.50	.128"	3.25	.156"	3.96	.030"	.762
ZSC000D	YES (Barrel)	Gold	.625"	15.87	.265"	6.73	.250"	6.35	.110"	2.79	.020"	0.50	.128"	3.25	.156"	3.96	.030"	.762
XSC000D	YES (Barrel)	Gold	.500"	12.70	.200"	5.08	.200"	5.08	.100"	2.54	.008"	0.20	.105"	2.67	.125"	3.18	.020"	0.50

MATERIAL AND FINISH:

CASE: C12L14 CRS
LEAD: Alloy 52
FINISH: GOLD per MIL-G-45204
TYPE II, CLASS 1 (std)
SILVER per QQ-S-365

DIMENSION TOLERANCE:

CASE LENGTH: +/- .010" (.250mm)
LEAD LENGTH: +/- .030" (.762mm)
LEAD DIAMETER: +/- .002" (.051mm)

IDENTIFICATION & LIMITS

OPERATING TEMP: -55°C to +125°C
INSTALLATION TEMPERATURE: 225°C - 250°C

ELECTRICAL

WORKING VOLTAGE: 200VDC
WITHSTAND VOLTAGE: 250% of WVDC (5 seconds)
INSULATION RESISTANCE:
10 Gig-Ohm Minimum
@ 25 Degrees Celcius
RATED DC CURRENT: 10 A

EMI FILTER COMPANY 12750 59th WAY NORTH CLEARWATER, FLORIDA 33760 (727) 585-7990 (727) 586-5138 Fax www.emifiltercompany.com			EMI PART NUMBER: SOLDER-IN "O" CAPACITANCE FEED-THROUGHS		
FSCM NO. OR9L0		DWG NO. SOLDERINFEEDTHRU _s REVC		REV C	
SCALE: NTS					