

2-56 UNC-2A THREADED
".0" CAPACITANCE FEED-THROUGHS

CIRCUIT

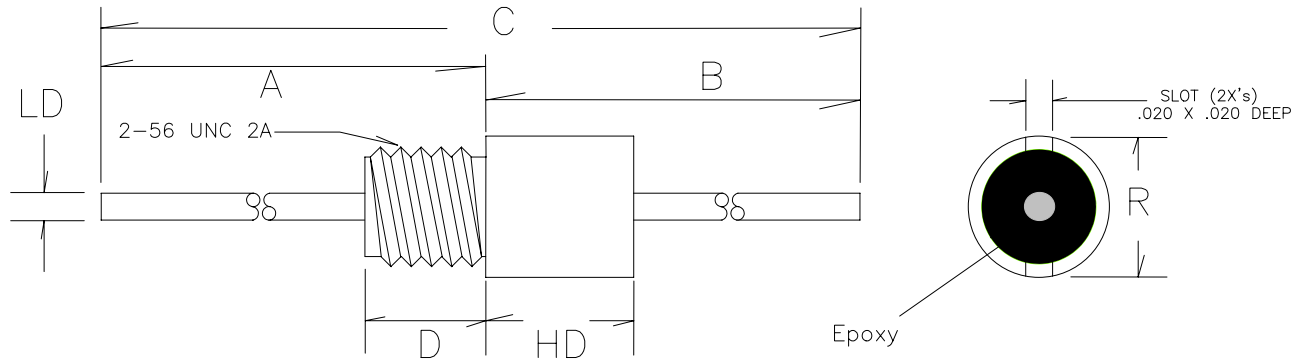

*RoHS Compliant * ISO 9001:2008 Registered*

EMI P/N	FINISH	A		B		C		D		HD		R		LD	
		Inches	mm	Inches	mm	Inches	mm	Inches	mm	Inches	mm	Inches	mm	Inches	mm
B2C000D	Gold	.270"	6.86	.270"	6.86	.540"	(13.71)	.090"	(2.29)	.110"	(2.79)	.105"	(2.67)	.020"	(.51)
B2C000D24	Gold	.270"	6.86	.270"	6.86	.540"	(13.71)	.090"	(2.29)	.110"	(2.79)	.105"	(2.67)	.024"	(.61)

MATERIAL AND FINISH:

CASE: Brass CASE FINISH: Gold
LEAD: Brass, 3/4 Hard
LEAD FINISH: Gold, Suitable For Wire Bond
Per MIL-G-45204, Type III, Grade A, Class 1

DIMENSION TOLERANCE:

CASE LENGTH: +/- .010" (.250mm)
HEAD DIAMETER (R): +/- .003" (.076mm)
LEAD LENGTH: +/- .030" (.762mm)
LEAD DIAMETER: +/- .002" (.051mm)

LIMITS:

OPERATING TEMP: -55° C to +125° C
INSTALLATION TEMP: N/A
MAXIMUM MOUNTING TORQUE: 1.0 in*lbs

WORKING VOLTAGE: 200VDC

WITHSTAND VOLTAGE:

250% of WVDC (5 seconds)

INSULATION RESISTANCE:

10 Gig-Ohm Minimum
@ 25 Degrees Celcius

DC CURRENT: 5 AMPS

EMI FILTER COMPANY
12750 59th WAY NORTH
CLEARWATER, FLORIDA 33760
(727) 585-7990
(727) 586-5138 Fax

www.emifiltercompany.com

EMI PART NUMBER: 2-56 SERIES
FEED-THROUGHS

FSCM NO.

OR9L0

DWG NO.

2-56FEEDTHRU's REVC

REV

C

SCALE:
NTS